

PARTS CATALOG

KM2V80

KIPOR

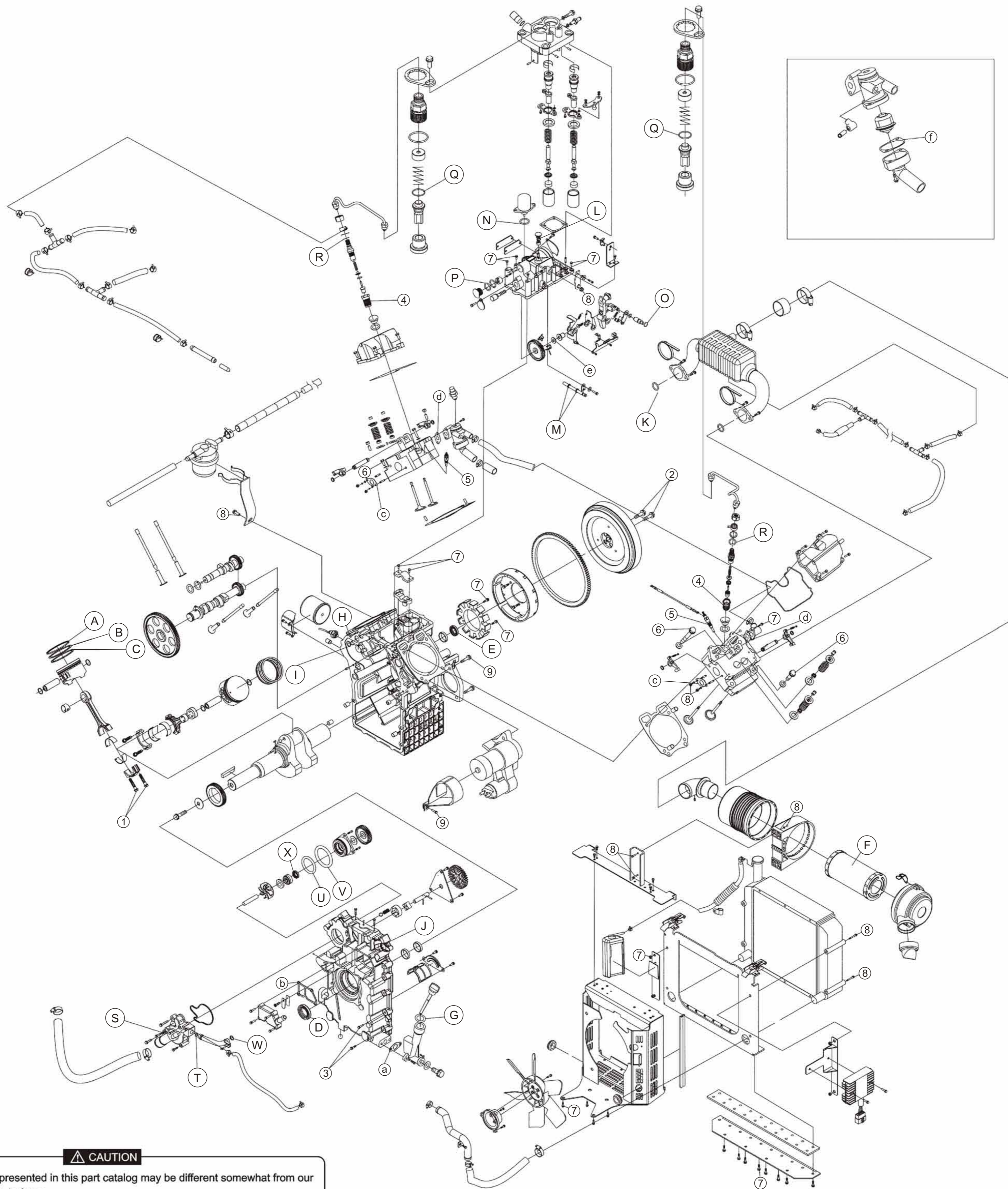

CAUTION

The structure presented in this part catalog may be different somewhat from our improved types in future.
Then You'd better refer parts catalog to the operation manual when using.

O-RING

Ref.No	Part.No	Description	Qty.	Mounted to
G	GB/T1235-1976	O-Ring 2.5×2.4	1	(01) Cylinder Block Assembly
H	GB/T3452.1-1992	O-Ring 5×1.8	2	(01) Cylinder Block Assembly
I	GB/T3452.1-1992	O-Ring 15.8×2.4	2	(01) Cylinder Block Assembly
J	GB/T3452.1-1992	O-Ring 23.6×1.8	1	(01) Cylinder Block Assembly
K	GB/T3452.1-1992	O-Ring 40×2.65	2	(02) Cylinder Head Assembly
L	GB/T3452.1-1992	O-Ring 10×1.8	1	(11) Governor Assembly
M	GB/T3452.1-1992	O-Ring 5×1.8	2	(11) Governor Assembly
N	GB/T3452.1-1992	O-Ring 28×1.8	1	(11) Governor Assembly
O	GB/T3452.1-1992	O-Ring 8.5×1.8	1	(11) Governor Assembly
P	GB/T3452.1-1992	O-Ring 18×1.8	2	(11) Governor Assembly
Q	GB/T3452.1-1992	O-Ring 16×2.65	2	(12) Fuel Injector Pump Assembly
R	GB/T3452.1-1992	O-Ring 10×1.8G	2	(13) Fuel Injector Assembly
S	GB/T3452.1-1992	O-Ring 8.0×1.8	1	(17) Cooling System
T	GB/T3452.1-1992	O-Ring 16×2.65	2	(17) Cooling System
U	GB/T3452.1-1992	O-Ring 50×1.8	1	(17) Cooling System
V	GB/T3452.1-1992	O-Ring 54.5×1.8	1	(17) Cooling System
W	GB/T3452.1-1992	O-Ring 15.8×2.4	1	(17) Cooling System

OIL SEALS

Ref.No	Part.No	Description	Qty.
X	KM2V80-17103	Output Oil Seal of Crankshaft	1

垫片组

Ref.No	Part.No	Description	Qty.
a	KM2V80-01013	Oil Refilling Base Washer	1
b	KM2V80-01023	Breather Cover Plate Washer	1
c	KM2V80-02017	Exhaust Pipe Washer	2
d	KM2V80-02018	Water Outlet Flange Washer	2
e	VE3-08-003	Flyweight Base Washer	2
f	KM2V80-17204	Thermal-regulator Shell Cover Washer	1

EASY DESTROYED PARTS

Ref.No	Part.No	Description	Qty.	Mounted to
A	KM2V80-04001	First Air Ring	2	(04) Piston & Connecting Rod Assembly
B	KM2V80-04002	Second Air Ring	2	(04) Piston & Connecting Rod Assembly
C	KM2V80-04100	Oil Ring Assembly	2	(04) Piston & Connecting Rod Assembly
D	KM2V80-01018	Output Oil Seal of Crankshaft	1	(01) Cylinder Block Assembly
E	KM2V80-01019	Flywheel Oil Seal of Crankshaft	1	(01) Cylinder Block Assembly
F	KM2V80-07300	Air Element Unit	1	(07) Air Intake System

FASTENING TORQUE OF MAIN BOLT & NUT (Unit:N.m)

Ref.No	Description	Qty.
①	Connecting Rod Bolt	28±2
②	Flywheel Bolt	80±5
③	Cylinder Cover Bolt	25 ^{±0.5}
④	Fuel Injector Screw Thread	60±10
⑤	Electro-thermal Plug	12±2
⑥	Cylinder Head Bolt	70±5
⑦	Standard M6 Bolt (Nut)	10 ^{±0.5}
⑧	Standard M8 Bolt (Nut)	23 ^{±0.5}
⑨	Standard M10 Bolt (Nut)	45 ^{±0.5}

WUXI KIPOR POWER CO., LTD.

11/F Suntime International Mansion, 450 Fushan Road, Pudong, Shanghai, China
TEL: 86-21-58208881 FAX: 86-21-58208877

